



# LB4024-3

The LITTLE-BLASTER equipment was designed for the hobbyist or very light production use. The LITTLE-BLASTER is constructed from heavy gauge metal, which is continuously welded. Also incorporated into the line are several products from the BLAST-IT-ALL<sup>®</sup> production blasting equipment, proven reliability such as the blast gun. The LITTLE-BLASTER is also designed for a small company to start blasting without a lot of expense.

While, the LITTLE-BLASTER is limited to specifically smaller sizes than production type equipment, but it is considered the highest caliber blaster manufactured today.



**BLAST-IT-ALL<sup>®</sup>**  
Salisbury, NC 28145  
(800) 535-2612  
[www.blast-it-all.com](http://www.blast-it-all.com)  
[sales@blast-it-all.com](mailto:sales@blast-it-all.com)



## LB 4024-3

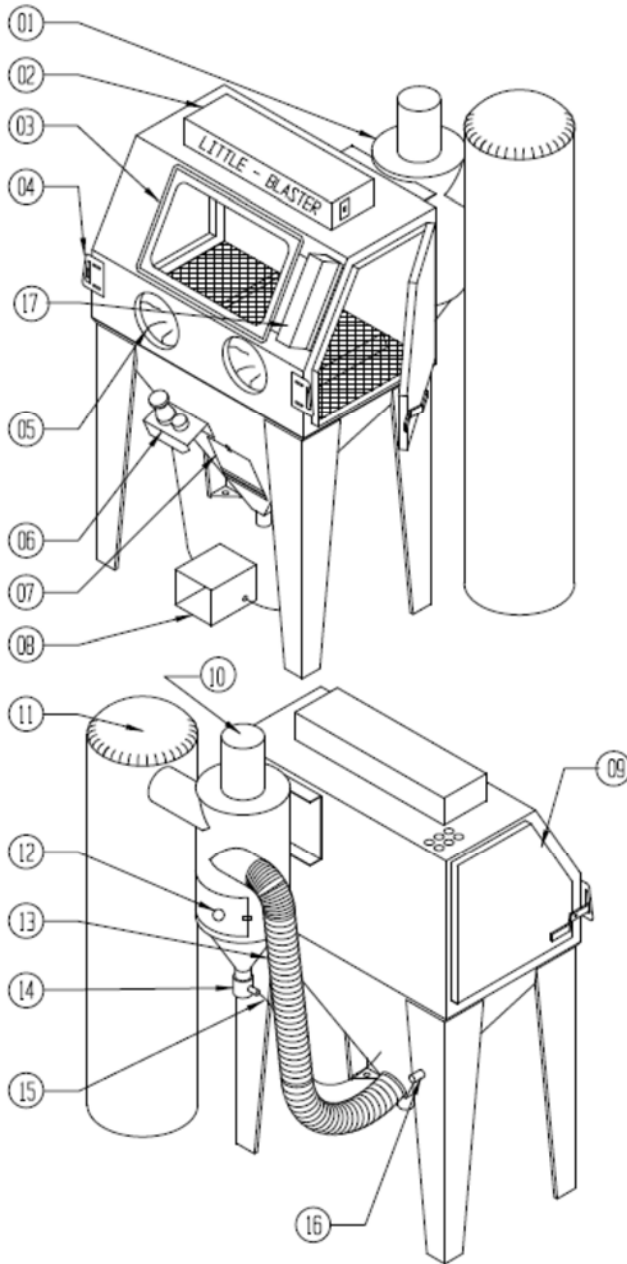

**1. Reclaimer:** High Performance 300 CFM cyclone type reclaimer separates good media from dust and by-products.

**2. Light Box:** Two (2) tube 24" fluorescent light, for best possible lighting in blast chamber, On-Off control switch for light and reclaimer.

**3. Viewing Window:**  
Large 12"x20" tempered glass provides long life and minimizes static build up of dust.  
Mylar Dispenser

**4. Door Latch:** Heavy-duty cam type, adjustable for positive door seal.

**5. Glove Arm Hole:** Heavy duty cloth lined vinyl snap-in gloves are quick changing.

### 6. Air Flow Regulator and Gauge:

Allows adjustable air pressure to gun for proper media flow to provide finish desired.

**7. Clean out door:** Easy access to filter screen, trapping heavy particles from abrasives. Allows recovery of small parts that may fall from blast chamber.

### 8. Safety Foot Control:

Prevents accidental blast operation.

**9. Doors:** Large double walled doors (both sides) for opening size. Knife sealing edge assures positive seal in blast chamber.

**10. Motor:** ½ HP, 120 volts, 11 amp, 3450 rpm, switch controlled.

**11. Dust Collector:** Cotton Sateen dust bag collects dust from reclaimer. Zipper in bottom for emptying dust and debris.

**12. Fill Door:** To add media to machine and remove debris screen basket inside reclaimer, adjustable air intake on door.

**13. Sump Hose:** 4" flexible duct hose, from machine sump outlet to reclaimer inlet.

**14. Media Valve:** Universal Feed allowing all types of abrasives to be used. 2" plug outlet for easy clean-out.

**15. Media Hose:** ½" media line hose from reclaimer media valve to bottom fitting on blast gun.

### 16. Compressed Air Inlet:

1/2" coupler for easy installation of optional moisture trap.

**17. Mylar Dispenser:** Mylar roll 12 ½ x 10 ft

### Media Blast Gun:

Lightweight aluminum pistol grip for long life. Interchangeable air jets and nozzles for various air supplies and media flow.

1/8" air jet supplied as standard. 5/32" - 3/16" air jets with sized nozzles supplied upon request.

### Machine Construction:

Heavy 14 gauge welded steel construction. Two coats of industrial quality paint.

### Packing:

Machine secured on wood pallet, reclaim packed under cabinet on same skid.

### Machine Options

Blow-Off nozzle Kit  
Air-Line Moisture Trap  
20" Set-In Turntable  
2 Gallon Tumble Basket

### Suction Gun Air Requirements Gun# 40 PSI 60 PSI 80 PSI

1/4" Nozzle - 1/8" Air Jet #4 12 CFM 17 CFM 21 CFM  
5/16" Nozzle - 5/32" Air Jet #5 19 CFM 27 CFM 34 CFM  
3/8" Nozzle - 3/16" Air Jet #6 27 CFM 37 CFM 47 CFM